

42296

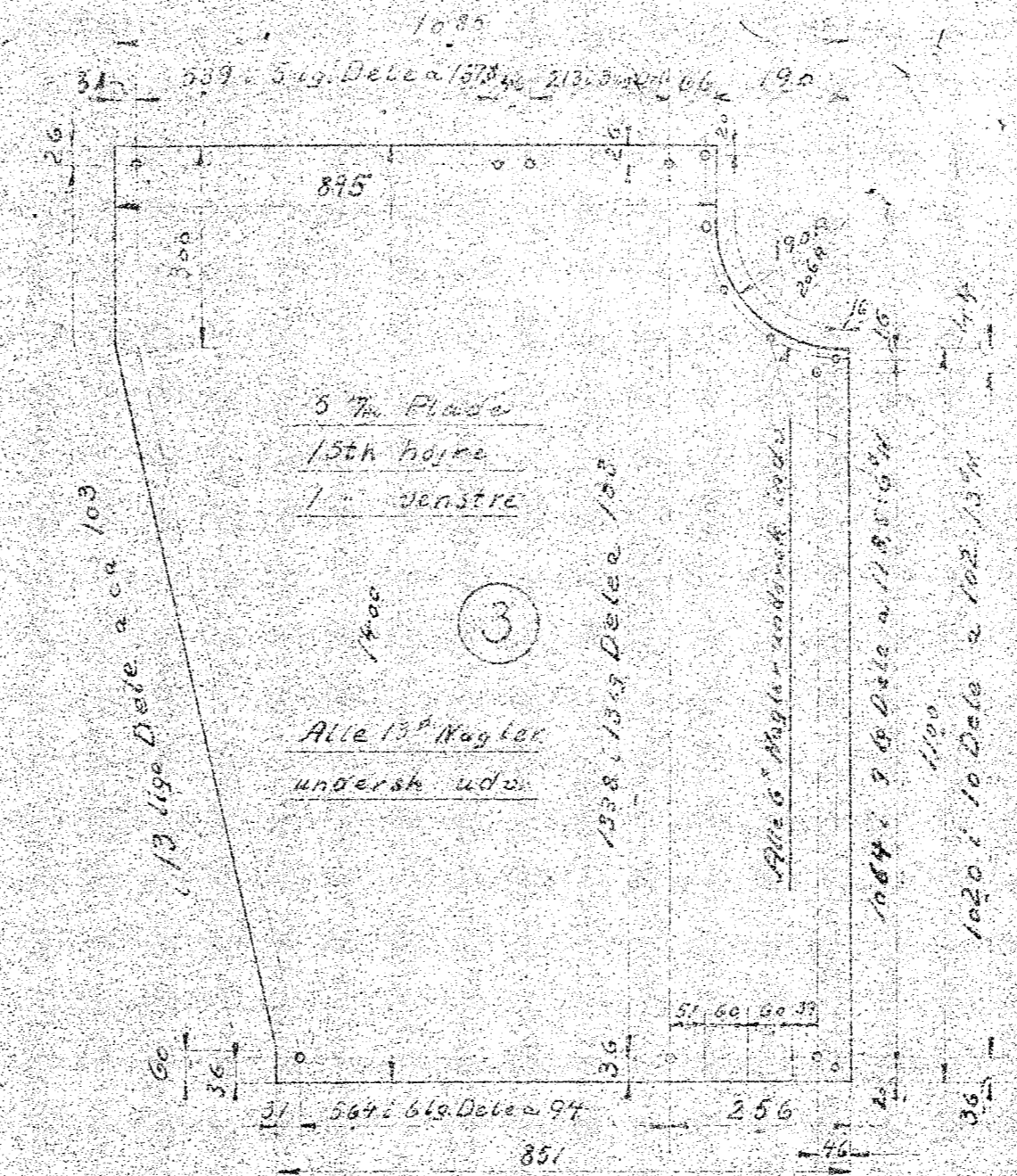

- 1. 1 Forplade Mast. 2610x410x5
- 2. 1 Bagplade " 2610x410x5
- 3. 2 Sideplader " 2050x410x5
- 4. 1 Bundplade " 2610x630x5
- 5. 2 Skroa de. " 1370x730x5
- 6. 1 Skilledeq. " 860x530x5
- 7. 1 Topplade " 2610x280x5

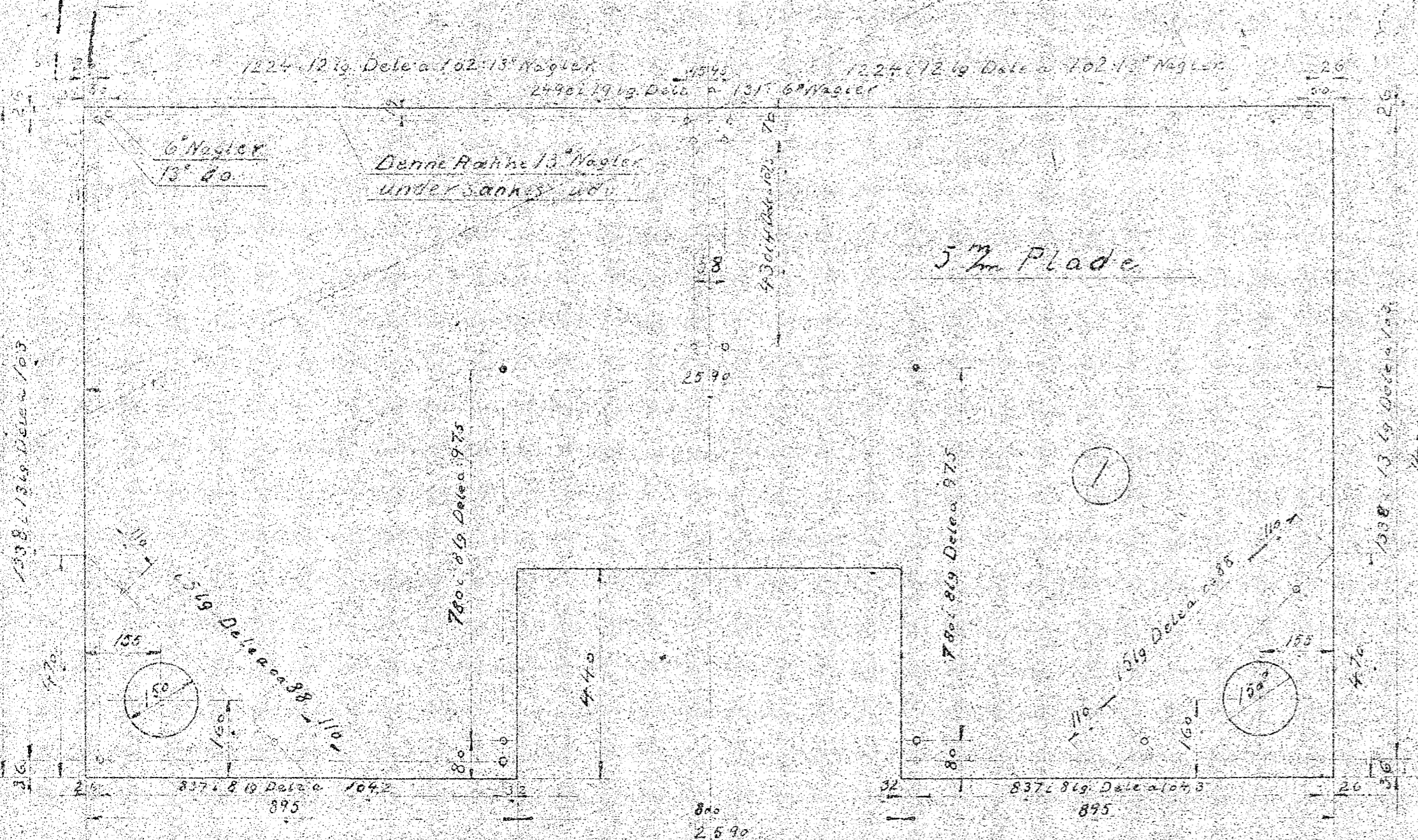
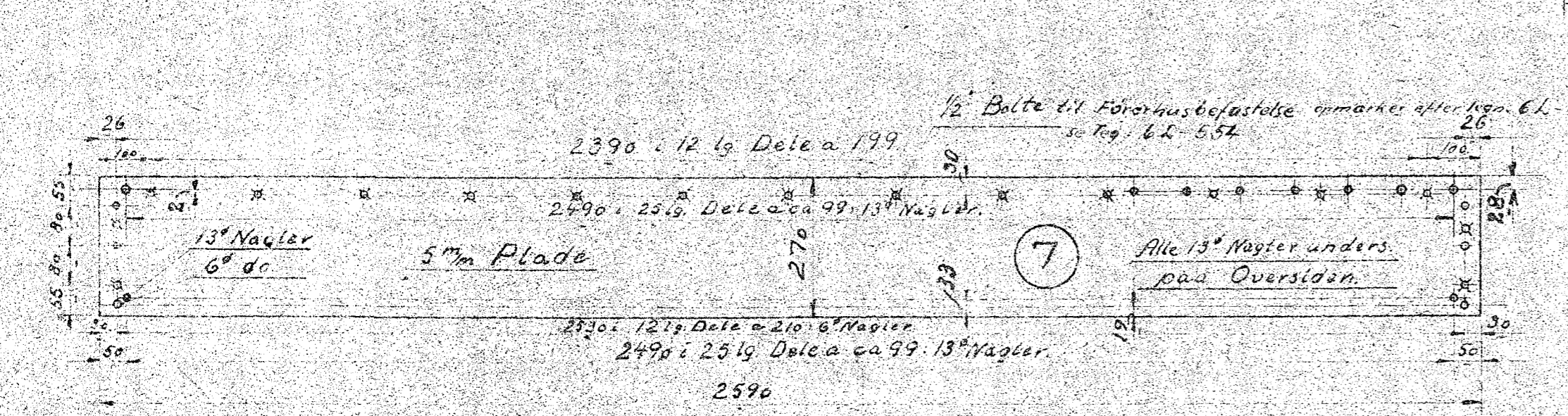
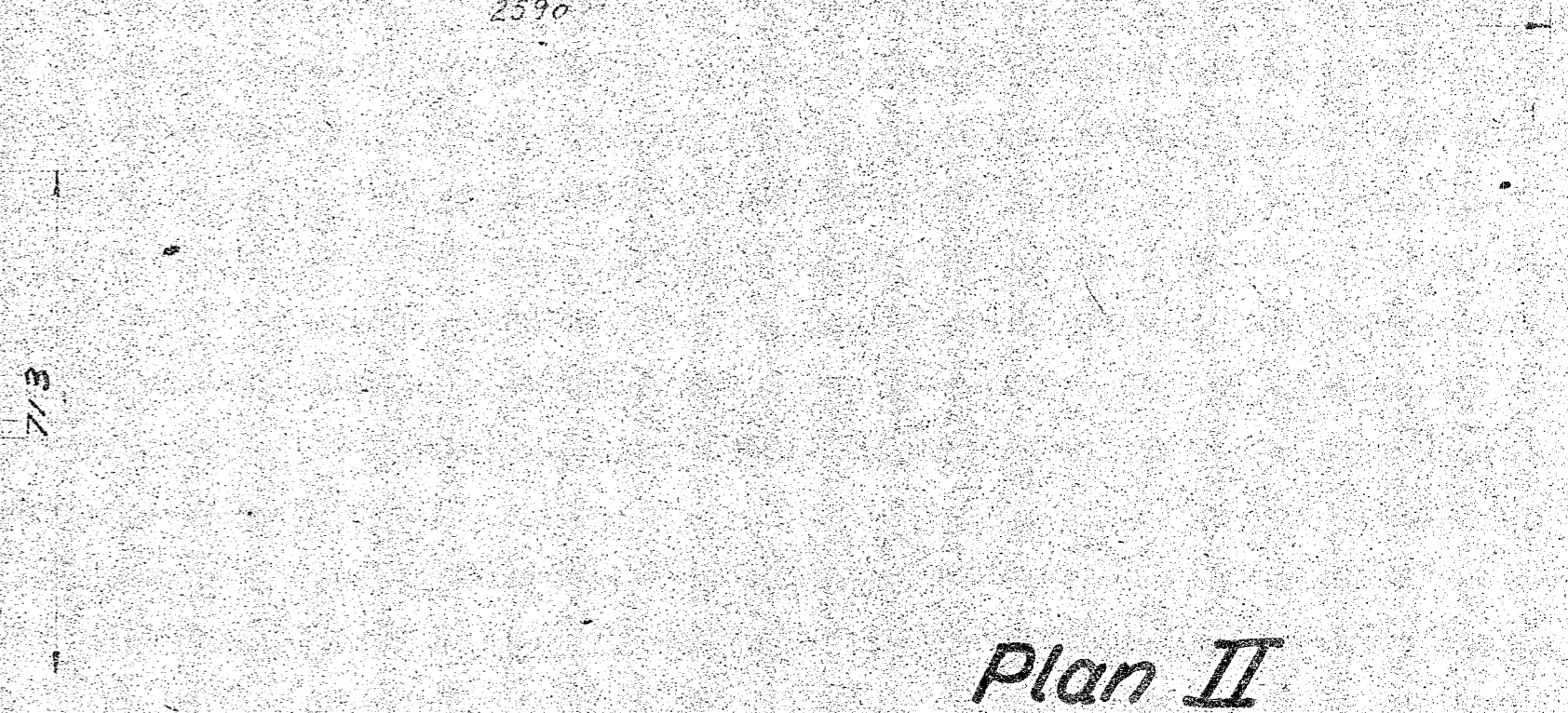
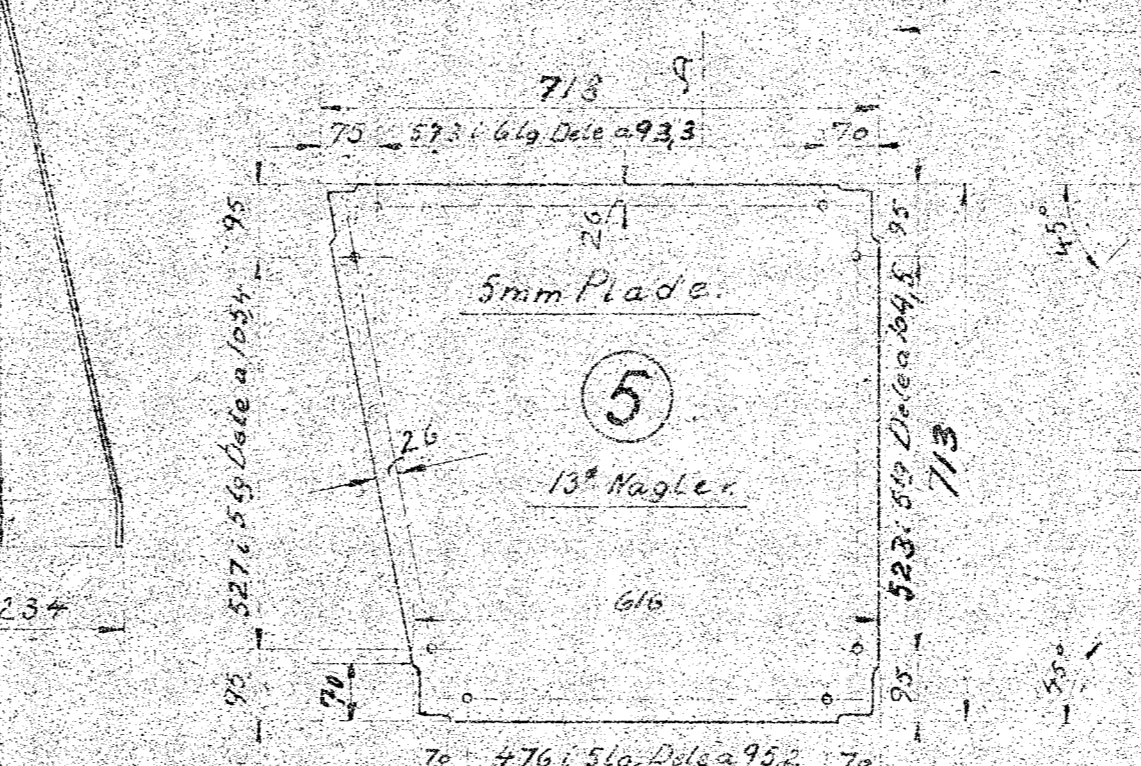
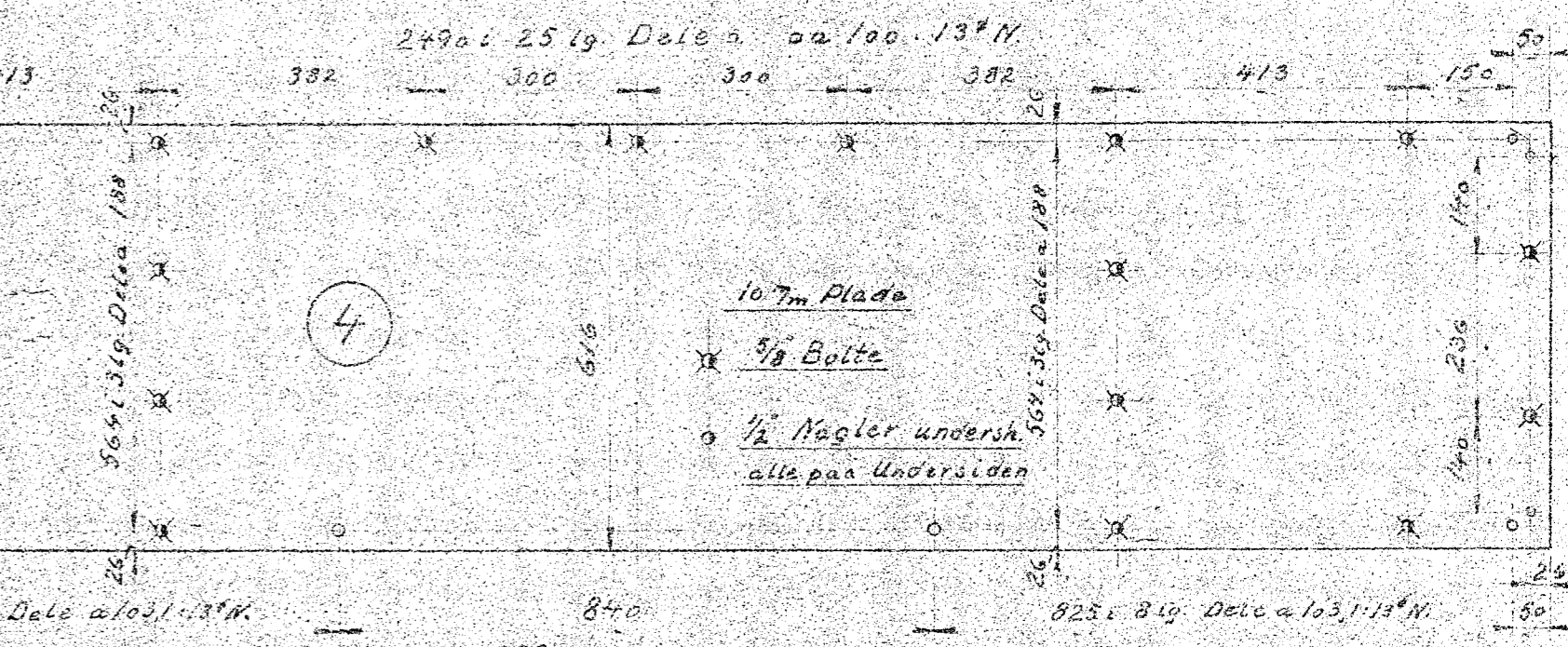
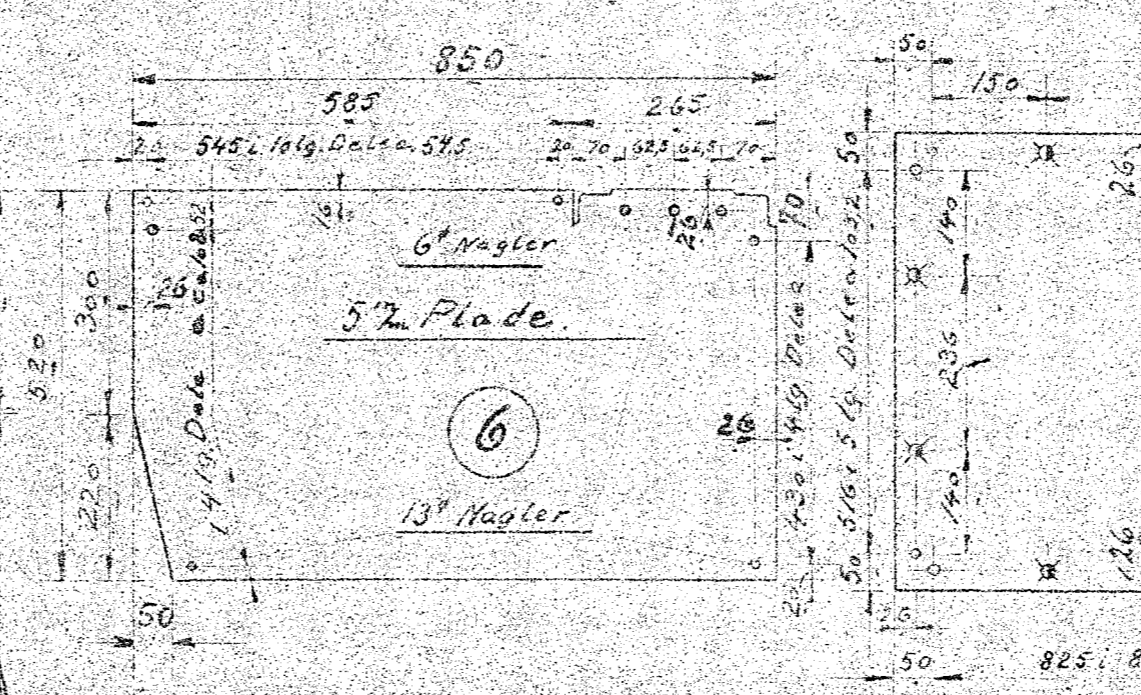
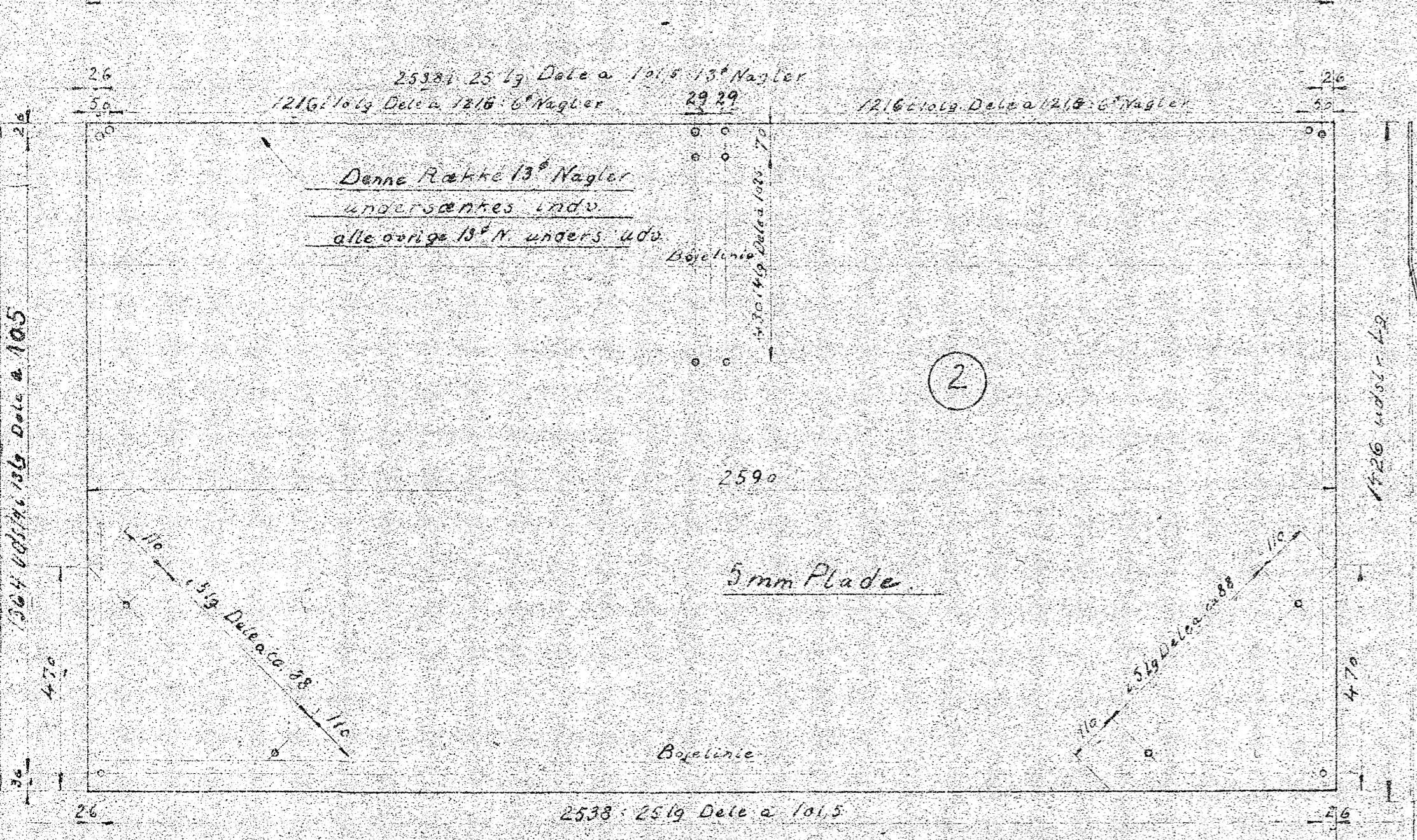

Plan II

A
Q.96

Forandringer, se plan I.

Plader til Kulkasse.	
D-Janderløkko Litra Q	
24.10.29	1:10
	6L-648